

MIRTO / MIRTO 230



*Wall mounted luminaire,
with plain and accurate design,
for outdoor applications.*

Technical Features

- Aluminium body, painted electrostatically in selected colour.
- Pure light without IR/UV radiation.
- Operation life: 50,000 hours with efficiency > 80% of the initial luminous flux (L80B10).
- Supplied with 3x0,75mm NEOPRENE 1m cable.

MIRTO / MIRTO 230

MIRTO

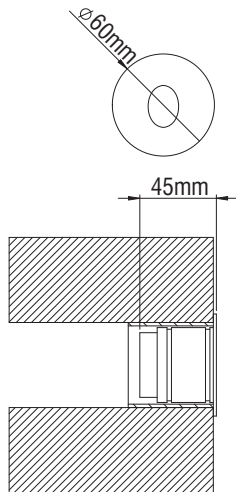
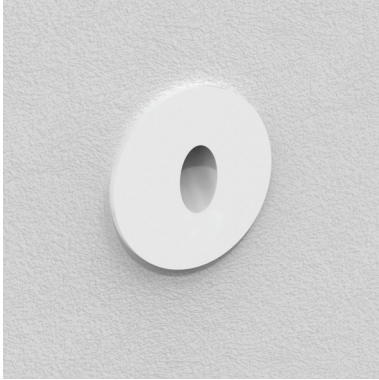

- Aluminium body.
- Connection for operation 12V DC.
- CRI: min. 80 / SCDM: 3
- Luminous Efficacy:
2W: 3000 K: 100 Lm/Watt
2W: 4000 K: 107 Lm/Watt

Code	Description	Kg
85837	MIRTO LED 2W IP65 Warm	0,400
85838	MIRTO LED 2W IP65 Neutral	0,400

MIRTO Q

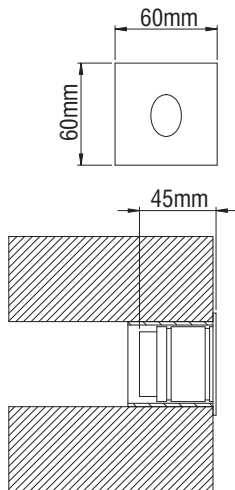
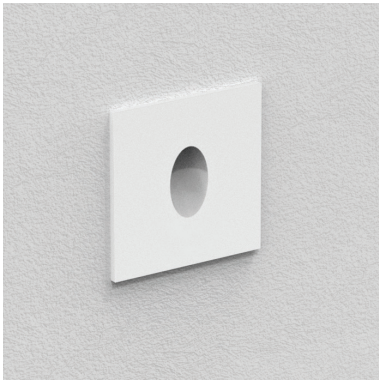

- Aluminium body.
- Connection for operation 12V DC.
- CRI: min. 80 / SCDM: 3
- Luminous Efficacy:
2W: 3000 K: 100 Lm/Watt
2W: 4000 K: 107 Lm/Watt

Code	Description	Kg
85848	MIRTO Q LED 2W IP65 Warm	0,400
85849	MIRTO Q LED 2W IP65 Neutral	0,400

DRIVER

LED LUMAIRES DESCRIPTION	N° Luminaires		DIMENSIONS mm	CODE	
	min.	max.			
MIRTO / MIRTO Q (CONSTANT VOLTAGE)	1	6	12V DC 13W IP20	160 x 22 x 19	800060

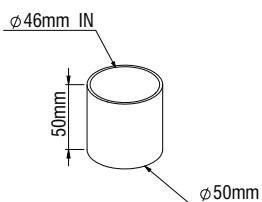

Outercasing (included)

Colour Codes:

0 Colours 1 White 2 Titan 3 Black 4 Chrome 5 matt Alum.

MIRTO / MIRTO 230

MIRTO 230

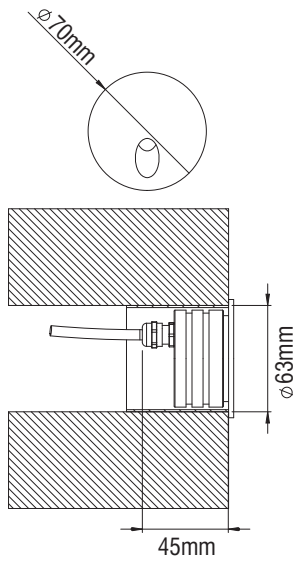
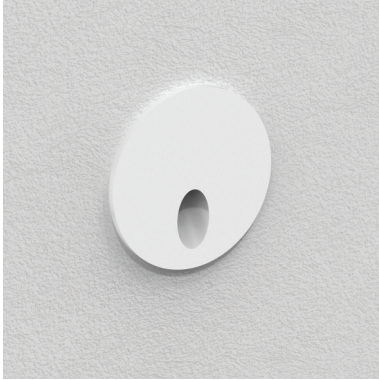

- Aluminium body.
- Dimmer Phase Cut.
- Power LED 230V AC/50Hz.
- CRI: min. 80 / SCDM: 3
- Luminous Efficacy:
4W: 3000 K: 90 Lm/Watt
4W: 4000 K: 95 Lm/Watt

Code	Description	Kg
85844	MIRTO 230 LED 4W IP65 Warm	0,400
85845	MIRTO 230 LED 4W IP65 Neutral	0,400

MIRTO 230 Q

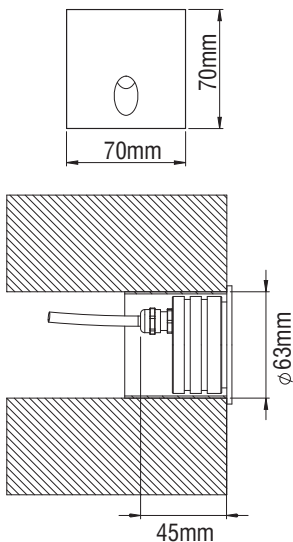
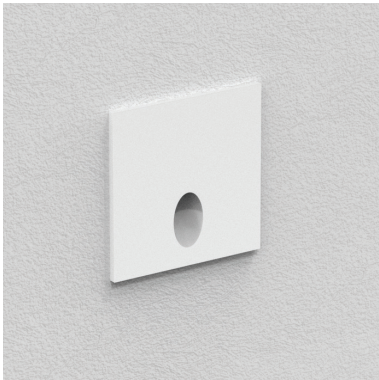

- Aluminium body.
- Dimmer Phase Cut.
- Power LED 230V AC/50Hz.
- CRI: min. 80 / SCDM: 3
- Luminous Efficacy:
4W: 3000 K: 90 Lm/Watt
4W: 4000 K: 95 Lm/Watt

Code	Description	Kg
85846	MIRTO 230 Q LED 4W IP65 Warm	0,400
85847	MIRTO 230 Q LED 4W IP65 Neutral	0,400

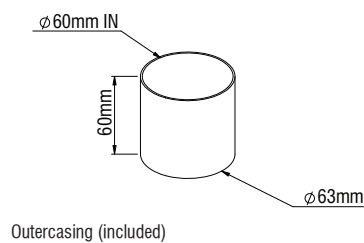
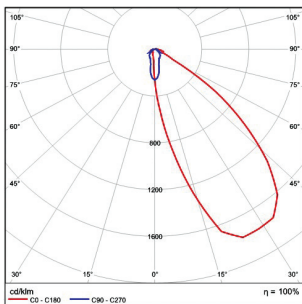

Colour Codes:

0 Colours 1 White 2 Titan 3 Black 4 Chrome 5 matt Alum.

MIRTO / MIRTO 230

